

METAL CLOSURE @ CANOPY

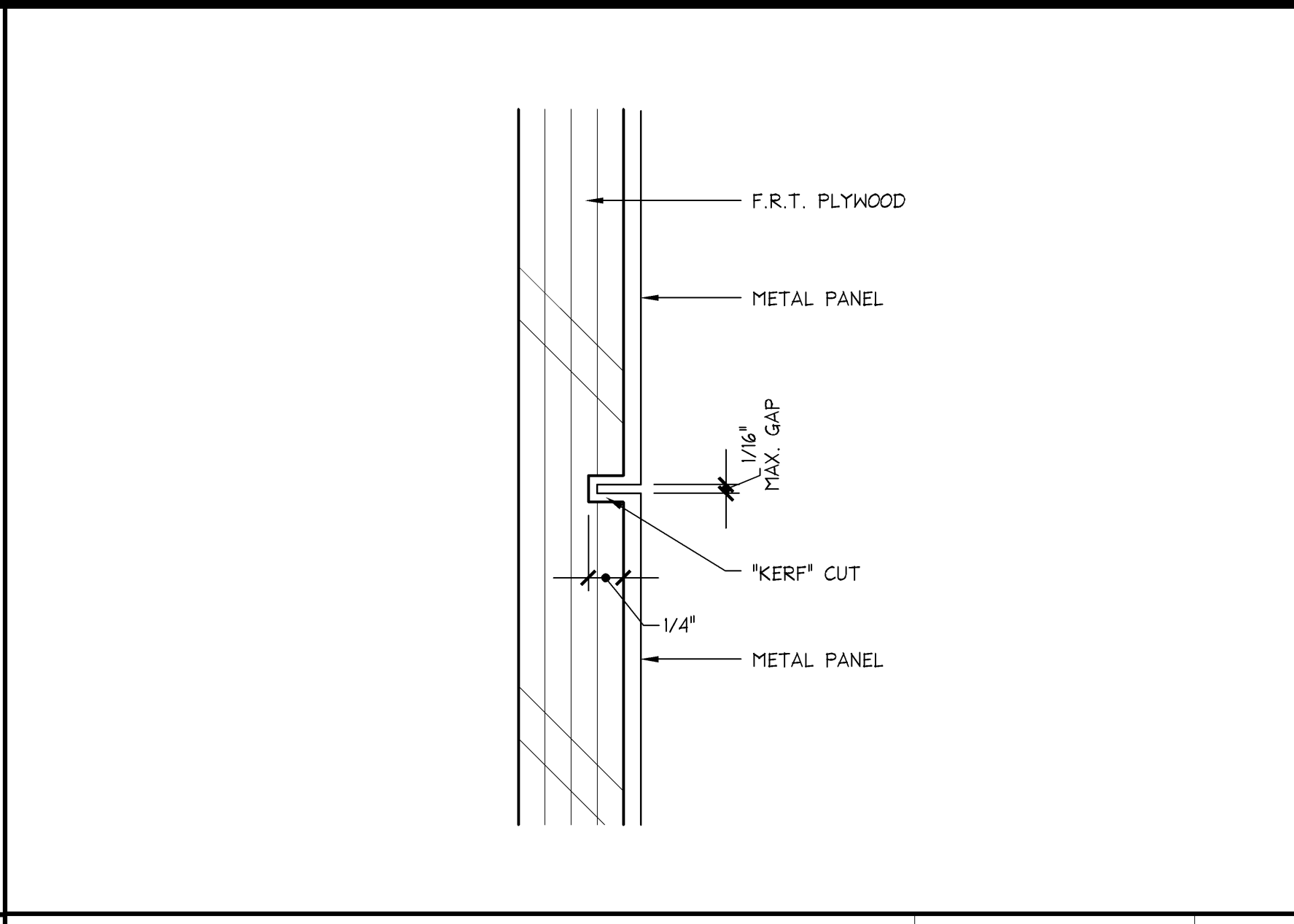

DETAIL @ BRAKE METAL

- ① PREFINISHED METAL PANEL MT-2
- ② PREFINISHED METAL PANEL W/ INTEGRAL REVEAL MT-5
- ③ 30" x 30" INTERNALLY ILLUMINATED PEDESTRIAN PLAQUE.
- ④ SHIPLAP WOOD PLANKING GF-2
- ⑤ SEAMS RANDOMLY LOCATED (NO SEAMS TO ALIGN WITHIN 4 PLANKS)
- ⑥ WINDOW FRAME MT-2
- ⑦ WOOD TRIM WD-W
- ⑧ WOOD VENEER COUNTERTOP WD-3
- ⑨ 1/2" CLEAR TEMPERED GLASS G-4
- ⑩ LEASELINE
- ⑪ (E) NEUTRAL PIER TO REMAIN. G.C. TO PATCH AND REPAIR AS REQ'D
- ⑫ (E) MALL BULKHEAD TO REMAIN. G.C. TO PATCH AND REPAIR AS REQ'D
- ⑬ 1/2" TEMPERED SLIDING GLASS DOOR. SEE DOOR SCHEDULE FOR HARDWARE & SHOP DRAWINGS
- ⑭ 16" HIGH WHITE FACE-LIT CHANNEL SIGNAGE WITH BLUE RETURNS
- ⑮ LINE OF METAL SEAM, FOR UNDERSIDE OF CANOPY, SEE C/A04.1
- ⑯ 3/4" METAL REVEAL
- ⑰ INTERNALLY ILLUMINATED LED GINGHAM TRANSOM - 1/2" STARFIRE GLAZING G-7 OVER 1/2" POLYCARBONATE PANEL WITH PRE-ATTACHED FILMS G-12
- ⑱ G.C. TO SEAL GAPS W/ CLEAR SILICONE
- ⑲ ALUM. WINDOW SYSTEM (KAWNER TRIFAB 451) - WRAPPED IN BRAKE METAL MT-2
- ⑳ LINE OF SLIDING DOOR TRACK ABOVE
- ㉑ BLIND GARAGE DOOR
- ㉒ 36" WIDE CLEAR (MIN) STOREFRONT EGRESS DOOR (PART OF SLIDING DOOR SYSTEM - REFER TO SHOP DRAWINGS)

STOREFRONT PLAN & ELEVATION KEYNOTES

STOREFRONT SIGNAGE TO BE SUBMITTED UNDER SEPARATE COVER

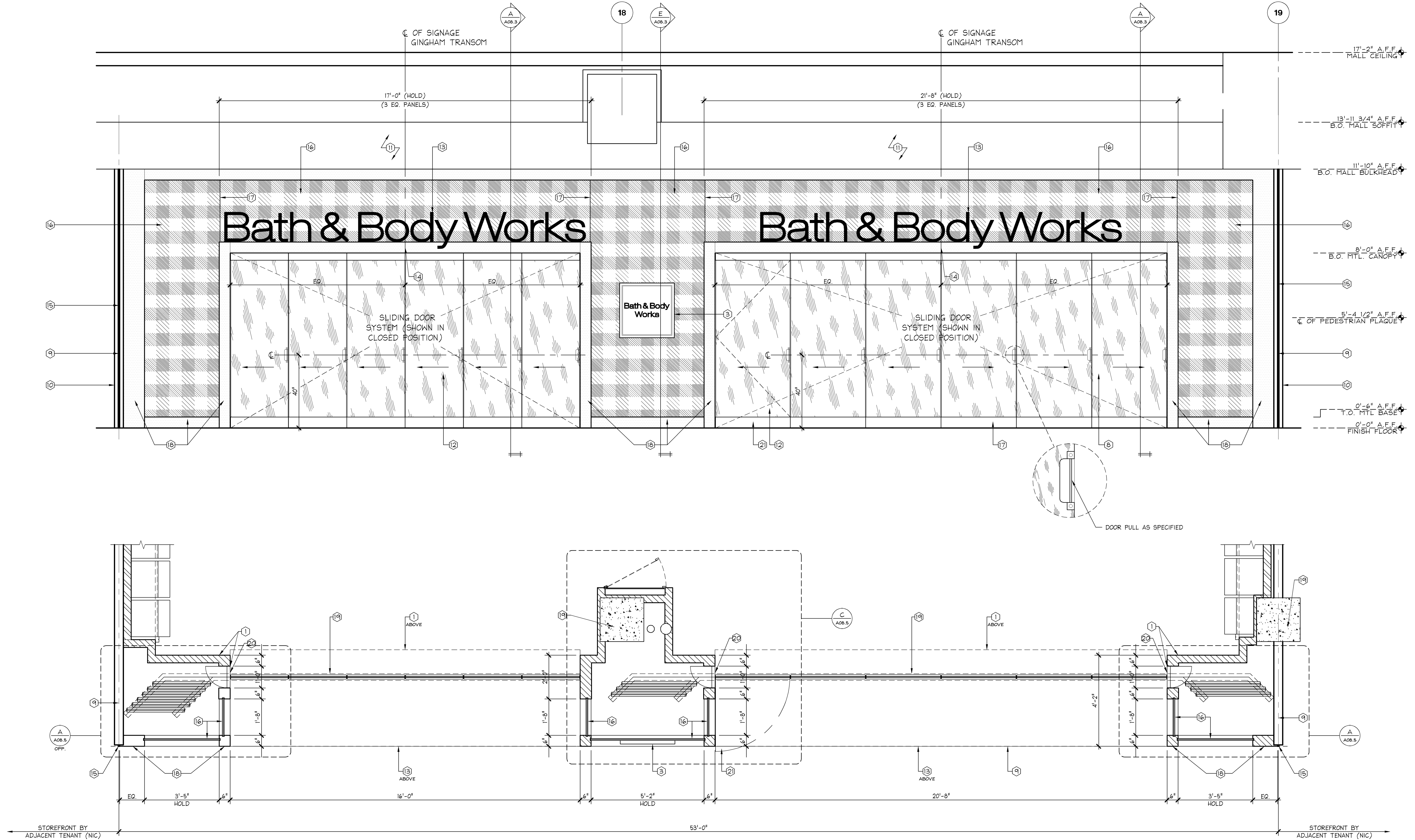

STOREFRONT PLAN & ELEVATION

**SHREMSHOCK**  
Shremshock Architects, Inc.  
6150 S. Sunbury Rd., Westerville, OH 43081  
t: 614 545 4550 | f: 614 545 4555 | shremshock.com  
Gerald S. Shremshock, Architect  
Timothy J. Shremshock, Architect

**Limited brands**  
LIMITED STORE PLANNING, INC.  
d/b/a STORE DESIGN & CONSTRUCTION  
Three Limited Parkway • Columbus, Ohio 43230  
Telephone: 614.415.7000 • Fax: 614.415.7349

PROJECT INFORMATION:  
**BATH & BODY WORKS**  
**THE GALLERIA II**  
SPACE AND MERCH RD.  
HOUSTON, TX 77056

REVISIONS:  
REQUIRED BY: DATE:

DATE ISSUED: 3/7/14  
DESIGNED BY: SB  
DRAWN BY: DGR  
CHECKED BY: RHW

STOREFRONT PLAN & ELEVATION

DRAWING NUMBER:  
**A08.1**

24200161  
BATH & BODY WORKS  
THE GALLERIA II  
SPACE AND MERCH RD.  
HOUSTON, TX 77056

PKG 1+  
14159  
130940

FULL REMODEL PACKAGE:  
EASTON-G  
00061216  
A/E PROJECT #: